

鑽孔機 >>>

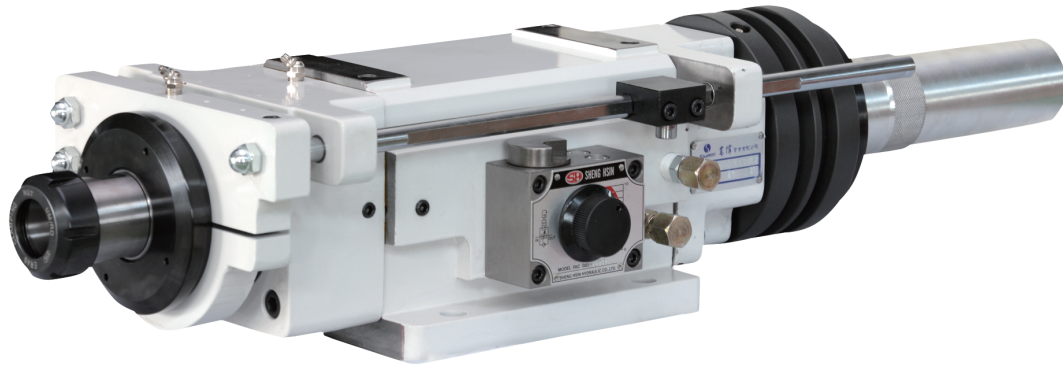

SWD8-150 / SWD8-200

鑽孔主軸頭 Drilling Spindle Units

規格 Norms	Model	SWD8-150	SWD8-200
鑽孔能力	Max. Drilling Capacity	φ35(S45C)	
最大行程	Max. Stroke	150mm	200mm
容許轉速	Spindle Max. Speed	1500RPM	
使用壓力	Working Pressura	液壓(H)20-35kg/cm ²	
缸 徑	Cylinder Bore	φ110	
缸徑面積	Cylinder Diameter	進給(F)71.2cm ² 復歸(B)31.4cm ²	
容許馬力	Maximum use of motor	5.5KW(7.5HP)	
傳動規格	Transmission Wheel Type	B-2-ODφ150 HTD-8M-58T	
淨 重	Net Weight	90kg	112kg
耗材 Consumables			
主軸軸承	Spindle Bearing	32010-1 32008-1 6010Z-1 6008Z-1	
皮帶輪軸承	Pulley Bearing	51213-1 6013Z-1	
活塞油封	Piston Seal (Oil pressure)	液壓 AP100-3 G65-1	
主軸油封	Spindle Oil Seal	TC-60x82x12-1	
前蓋油封	Front Cover Oil Seal (Oil pressure)	液壓 TC-90x110x12-1 G115-1 G105-1 P90-2	
	Oilless Slide Bearings	DU-14x20 -2(自潤軸承)	
後蓋油封	Rear Cover Oil Seal (Oil pressure)	液壓 G115-1 G105-1 P55-2	
	Oilless Slide Bearings	DU-14x25 -1(自潤軸承)	

SWD8-150-ER50

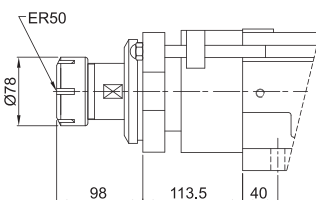

SWD8-150-FA25

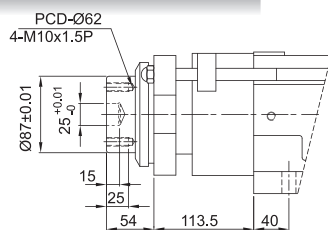

SWD8-150-MT4

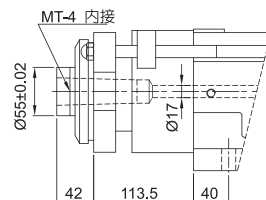

SWD8-150-MT4A

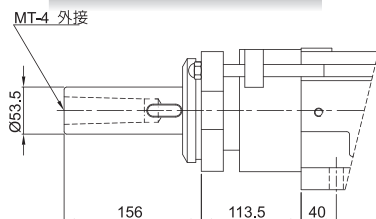

夾持型式SWD8-200尺寸同SWD8-150

SWD8-150-ER40-R

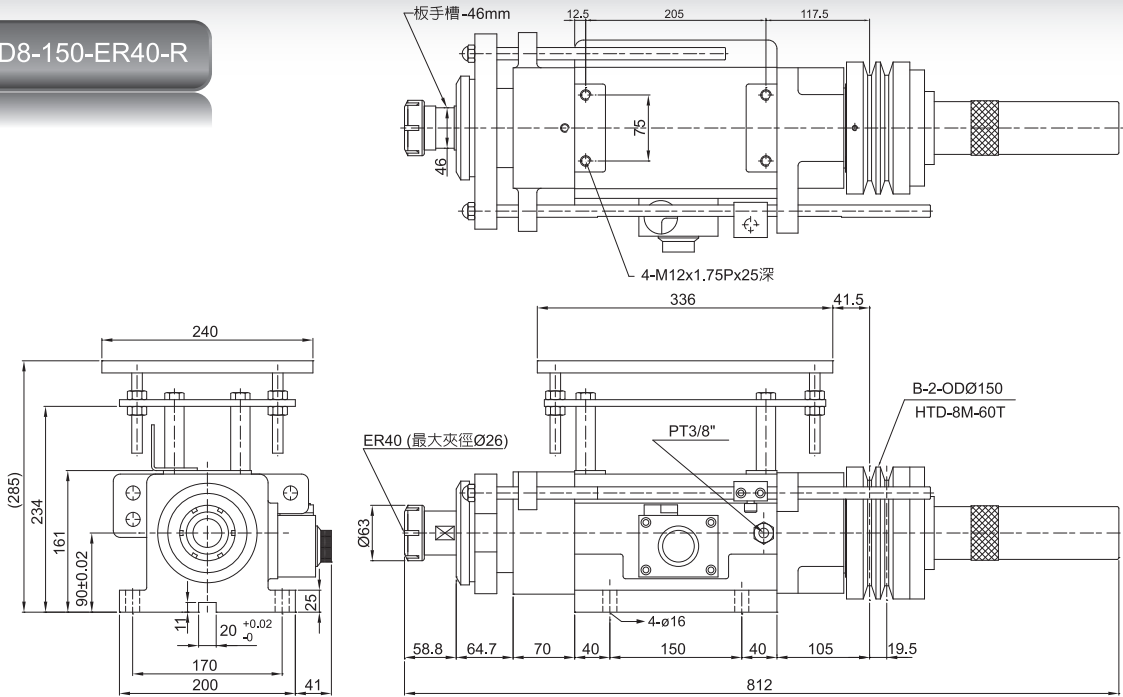

SWD8-200-ER40-R

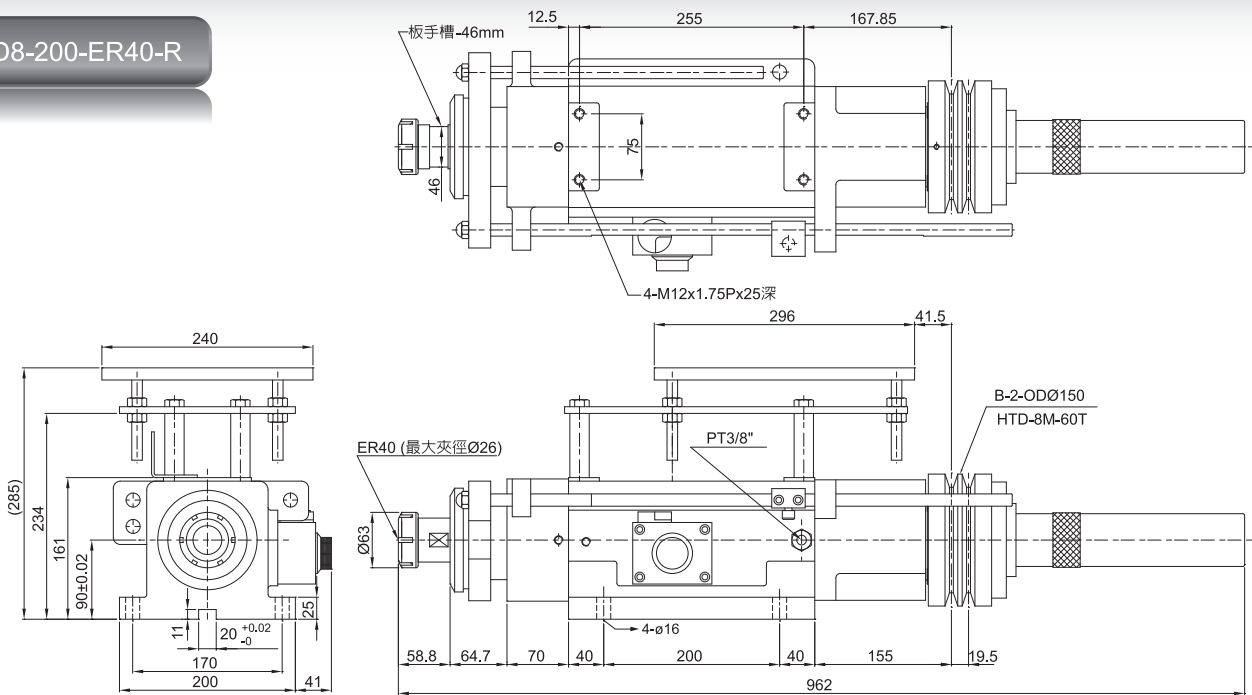

SWD8-150-NT40

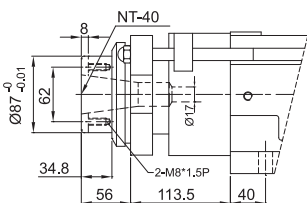

SWD8-150-NT30

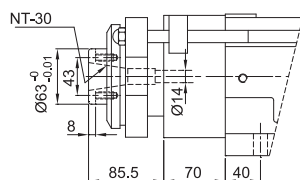

SWD8-150-AS32

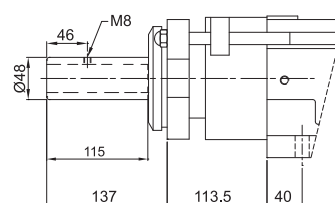

SWD8-150-MT4B-HP

