

攻牙器 >>>



絲攻尺寸表(JIS)

PT	PS	PF	直徑	四角
1/8	1/8	1/8	8	6
1/4	1/4	1/4		9
3/8	3/8	3/8	14	11
1/2	1/2	1/2	18	14
		5/8	19	15
3/4	3/4	3/4	23	17
		7/8	24	19
1	1	1	26	21
	1 1/8	1 1/8	28	21
1 1/4	1 1/4	1 1/4	32	26
1 3/8	1 3/8	1 3/8	35	26
1 1/2	1 1/2	1 1/2	38	29

公制	英制	英制	直徑	四角
M3		W1/8	4	3.1
M4	M4.5		5	4
M5	M5.5		5.5	4.5
M6		U1/4	6	4.5
		U5/16	6.1	5
M8	M7		6.2	5
M10	M9	U3/8	7	5.5
	M11	U7/16	7	6
M12			8.5	6.5
		U1/2	9	7
	M14	U9/16	10.5	8
	M15	U5/8	12	9
M16			12.5	10
	M17		13	10
M18		U3/4	14	11
M20			15	12
	M22	U7/8	17	13
M24	M25		19	15
	M27	U1	20	15
	M28		21	17
		U1 1/8	22	17
M30			23	17
	M32	U1 1/4	24	19
	M33		25	19
	M35	U1 3/8	26	21
M36	M38		28	21
	M39	U1 1/2	30	23
M42			32	26
	M45	U1 3/4	35	26
M48		W1 7/8	38	29

攻牙器 >>>

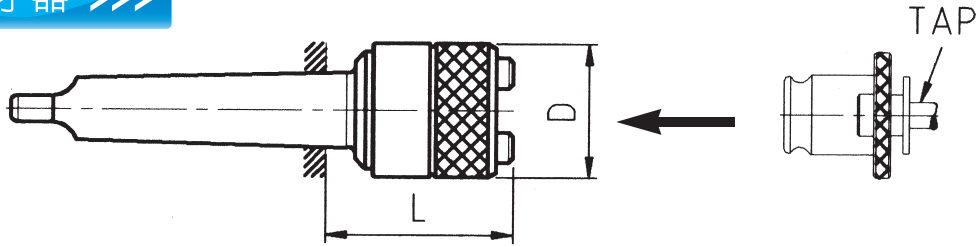

規格	攻牙能力		D	L	Weight(kg)
TH0 / MT1	M3~M8	U 1/4~U 5/16	23	39	0.1
TH1 / MT2	M3~M14	U 1/4~U 7/16   Pipe Thread P1/8~P1/4	32	44	0.2
TH2 / MT3	M6~M24	U 1/4~U 7/8   Pipe Thread P1/8~P1/2	50	61	0.7
TH3 / MT4	M16~M40	U 5/8~U 3/8   Pipe Thread P1/4~P1 1/8	72	91	2.1
TH4 / MT5	M22~M50	U 7/8~U1 3/4	95	109	3.6

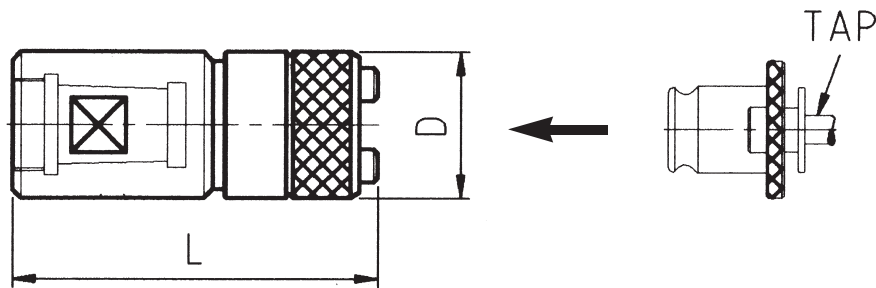

規格	攻牙能力		D	L	Weight(kg)
TH0 / JT2(Thread)	M3~M8	U 1/4~U 5/16	23	55	0.2
TH1 / JT2(Thread)	M3~M14	U 1/4~U 7/16   Pipe Thread~P1/8~P1/4	32	76	0.29
TH1 / JT6(Thread)				80	
TH2 / JT6(Thread)	M6~M24	U 1/4~U 7/8   Pipe Thread P1/8~P1/2	50	100	0.5

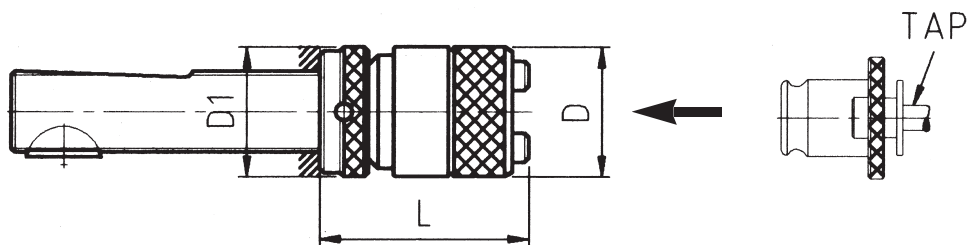

規格	攻牙能力		D	D1	L(MIN)	Weight(kg)
TH0 / Tr.16 1.5	M3~M8	U 1/4~U 5/16	23	25	45	0.2
TH1 / Tr.20 2	M3~M14	U 1/4~U 7/16   Pipe Thread P1/8~P1/4	32	32	49	0.3
TH2 / Tr.28 2	M6~M24	U 1/4~U 7/8   Pipe Thread P1/8~P1/2	50	40	66	0.9
TH3 / Tr.36 2	M16~M40	U 5/8~U 3/8   Pipe Thread P1/4~P1 1/8	72	50	97	2.5
TH4 / Tr.48 2	M22~M50	U 7/8~U1 3/4	95	72	118	4.0



## 徑向浮動攻牙器 &gt;&gt;&gt;

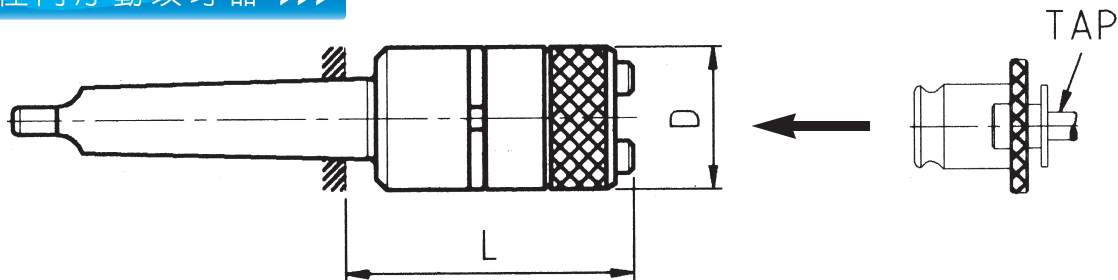

規格	攻牙能力		Float	D	L	Weight(kg)
THP 0 /MT1	M3~M8	U 1/4~U 5/16	0.25	23	59	0.1
THP 1 /MT2	M3~M14	U 1/4~U 7/16   Pipe Thread P1/8~P1/4	0.5	32	65	0.3
THP 2 /MT3	M6~M18	U 1/4~U 3/4	1	50	91	1.2
THP 3 /MT4	M16~M40	U 5/8~U 3/8   Pipe Thread P1/4~P1 1/8	1.5	72	132	3.3
THP 4 /MT5	M22~M50	U 7/8~U1 3/4	2	95	162	4.8

## 配合珠槽螺帽 &gt;&gt;&gt;

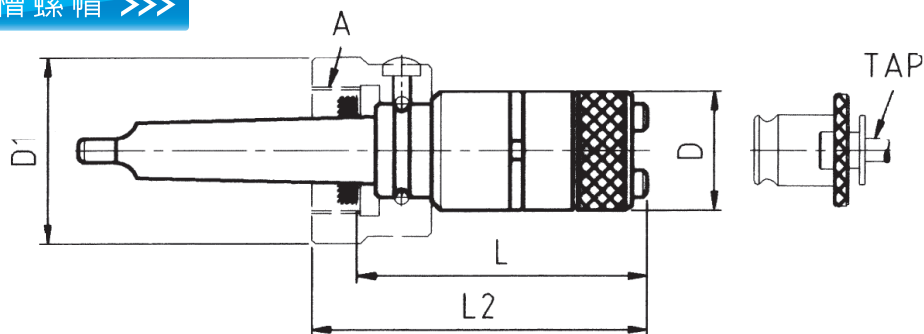

規格	攻牙能力			Float	D	D1	L	L2	A	Weight(kg)
THP 1 /MT2 ( 4 )	M3~M14	U 1/4~U 7/16	Pipe Thread P1/8~P1/4	0.5	32	32	85	98	M34XP2.0	0.4
THP 2 /MT2 ( 4 )	M6~M24	U 1/4~U 7/8	Pipe Thread P1/8~P1/2	1	50	50	106	119	M34XP2.0	1.2
THP 2 /MT3 ( 4 )	M6~M24	U 1/4~U 7/8	Pipe Thread P1/8~P1/2	1	50	50	108	120	M45XP2.0	1.3
THP 3 /MT3 ( 4 )	M16~M40	U 5/8~U 3/8	Pipe Thread P1/4~P1 1/8	1.5	72	72	146	158	M45XP2.0	3.4

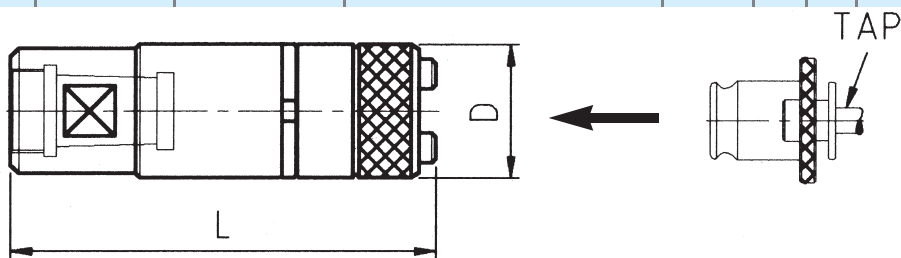

規格	攻牙能力		Float	D	L	Weight(kg)
THP 0 /JT2 (Thread)	M3~M8	U 1/4~U 5/16	0.25	23	90	0.09
THP 1 /JT2 (Thread)	M3~M14	U 1/4~U 7/16   Pipe Thread~P1/8~P1/4	0.5	32	98	0.43
THP 1 /JT6 (Thread)					102	
THP 40 /JT6 (Thread)	M6~M18	U 1/4~U 3/4	0.75	40	120	0.7
THP 2 /JT6 (Thread)	M6~M24	U 1/4~U 7/8   Pipe Thread P1/8~P1/2	1	50	128	1.11

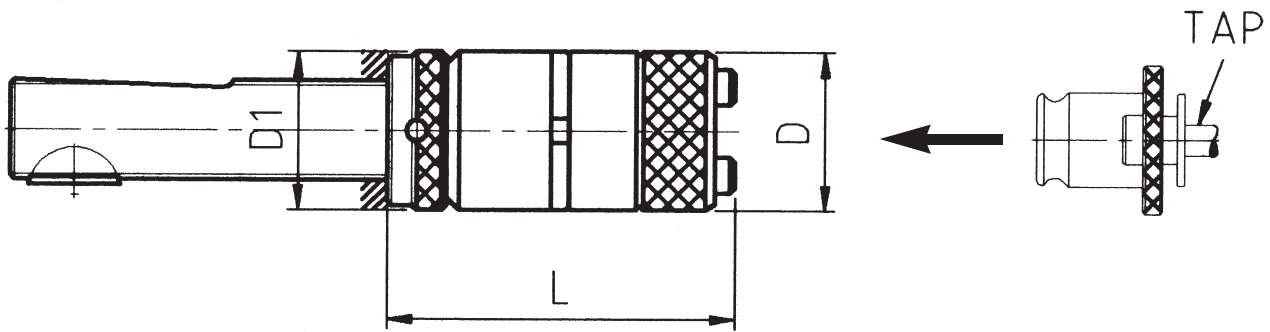
 徑向浮動攻牙器 >>>

規格	攻牙能力		Float	D	D1	L(MIN)	Weight(kg)
THP 0 /Tr.16 1.5	M3~M8	U 1/4~U 5/16	0.25	23	25	65	0.2
THP 1 /Tr.20 2	M3~M14	U 1/4~U 7/16   Pipe Thread P1/8~P1/4	0.5	32	32	70	0.5
THP 40 /Tr.28 2	M6~M18	U 1/4~U 3/4	0.75	40	40	89	0.9
THP 2 /Tr.28 2	M6~M24	U 1/4~U 7/8   Pipe Thread P1/8~P1/2	1	50	40	96	1.5
THP 3 /Tr.36 2	M16~M40	U 5/8~U 3/8   Pipe Thread P1/4~P1 1/8	1.5	72	50	138	3.7
THP 4 /Tr.48 2	M22~M50	U 7/8~U1 3/4	2	95	72	171	5.0

JIS	攻牙能力		Float	D	D1	L(MIN)	Weight(kg)
THP1/Tr16X1.5							
THP1/Tr19X1.5	M3~M14	U 1/4~U 7/16   Pipe Thread P1/8~P1/4	0.5	32	32	70	0.5
THP1/Tr22X1.5							
THP2/Tr22X2	M6~M24	U 1/4~U 7/8   Pipe Thread P1/8~P1/2	1	50		96	1.5
THP2/Tr32X2							
THP3/Tr32X2	M16~M40	U 5/8~U 3/8   Pipe Thread P1/4~P1 1/8	1.5	72	50	138	3.5



軸向伸縮攻牙器 >>>

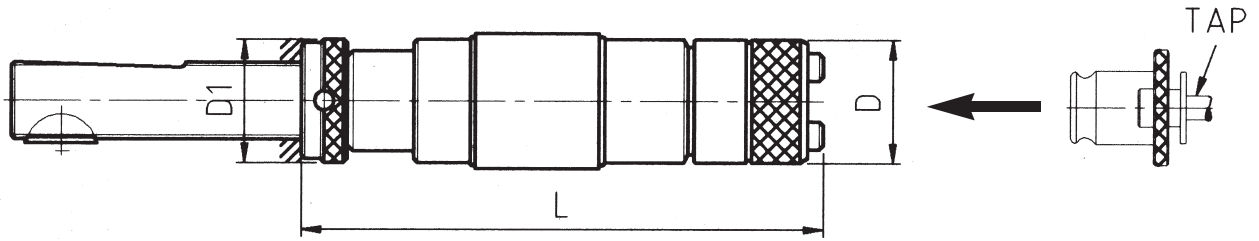

規格	攻牙能力		Length compensation		D	D1	L(MIN)	Weight(kg)	
			Comp.	Exp.					
THL 030-20 Tr.16X1.5	M3~M8	U 1/4~U 5/16		20	10	23	25	45	0.2
THL 140-20 Tr.20X2	M3~M14	U 1/4~U 7/16	Pipe Thread P1/8~P1/4	20	20	32	32	49	0.3
THL 240-20 Tr.28X2	M6~M24	U 1/4~U 7/8	Pipe Thread P1/8~P1/2	20	20	50	40	66	0.9
THL 340-20 Tr.36X2	M16~M40	U 5/8~U 3/8	Pipe Thread P1/4~P1 1/8	20	20	72	50	97	2.5
THL 460-30 Tr.48X2	M22~M50	U 7/8~U1 3/4		30	30	95	72	118	4.0

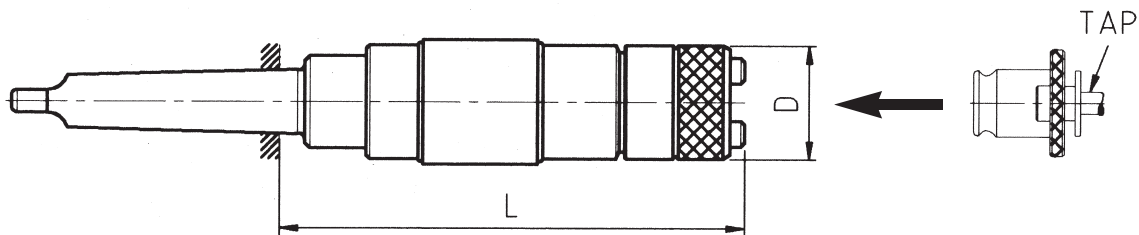

規格	攻牙能力		Length compensation		D	L(MIN)	Weight(kg)	
			Comp.	Exp.				
THL 030-20 MT1	M3~M8	U 1/4~U 5/16		20	10	23	45	0.2
THL 140-20 MT2	M3~M14	U 1/4~U 7/16	Pipe Thread P1/8~P1/4	20	20	35	49	0.3
THL 240-20 MT3	M6~M24	U 1/4~U 7/8	Pipe Thread P1/8~P1/2	20	20	50	66	0.9
THL 340-20 MT4	M16~M40	U 5/8~U 3/8	Pipe Thread P1/4~P1 1/8	20	20	72	97	2.5
THL 460-30 MT5	M22~M50	U 7/8~U1 3/4		30	30	95	118	4.0

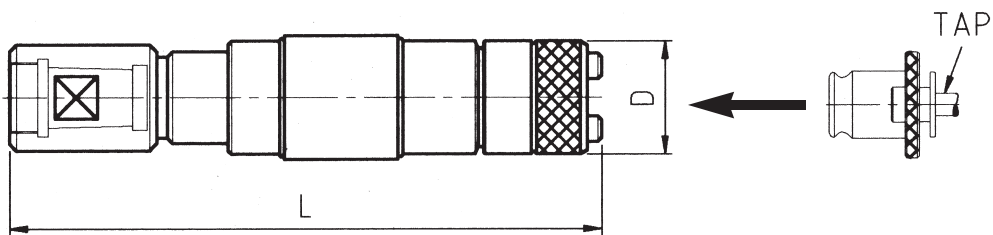

規格	攻牙能力		Length compensation		D	L(MIN)	Weight(kg)	
			Comp.	Exp.				
THL 030-15/JT2(Thread)	M3~M8	U 1/4~U 5/16		15	15	23	148	0.18
THL 140-20/JT2(Thread)	M3~M14	U 1/4~U 7/16	Pipe Thread P1/8~P1/4	20	20	35	167	0.5
THL 140-20/JT6(Thread)							171	
THL 240-20/JT6(Thread)	M6~M24	U 1/4~U 7/8	Pipe Thread P1/8~P1/2	20	20	50	190	1.5

攻牙器 | Trade max

軸向伸縮攻十徑向浮動牙器 >>>

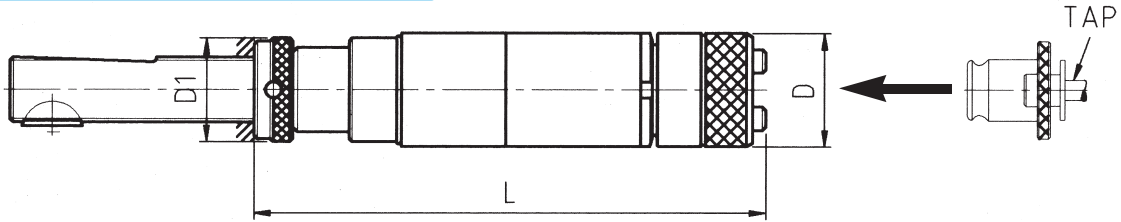

規格	攻牙能力		Float	Length compensation		D	D1	L(MIN)	Weight(kg)
				Comp.	Exp.				
THLP 030-20/Tr.16X1.5	M3~M8	U 1/4~U 5/16	0.25	20	10	23	25	138	0.4
THLP 140-20/Tr.20X2	M3~M14	U 1/4~U 7/16   Pipe Thread P1/8~P1/4	0.5	20	20	35	32	153	0.9
THLP 240-20/Tr.28X2	M6~M24	U 1/4~U 7/8   Pipe Thread P1/8~P1/2	1	20	20	50	40	186	2.5
THLP340-20/Tr.36X2	M16~M40	U 5/8~U 3/8   Pipe Thread P1/4~P1 1/8	1.5	20	20	72	50	244	5.8
THLP 460-30/Tr.48X2	M22~M50	U 7/8~U1 3/4	2	30	30	95	72	316	

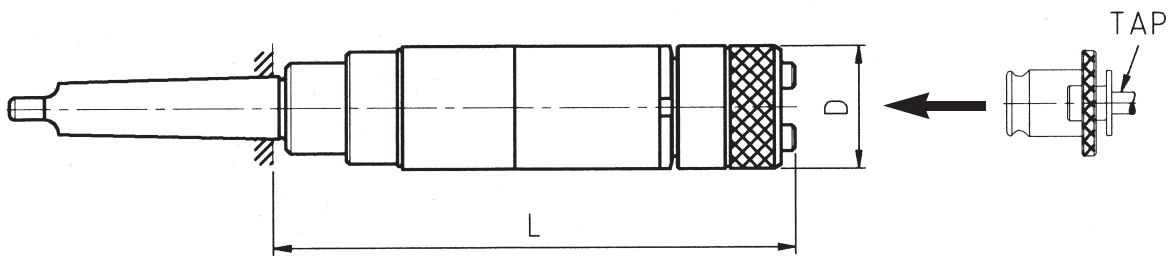

規格	攻牙能力		Float	Length compensation		D	D1	L(MIN)	Weight(kg)
				Comp.	Exp.				
THLP 030-20/MT1	M3~M8	U 1/4~U 5/16	0.25	20	10	23	25	132	0.3
THLP 140-20/MT2	M3~M14	U 1/4~U 7/16   Pipe Thread P1/8~P1/4	0.5	20	20	35	32	148	0.8
THLP 240-20/MT3	M6~M24	U 1/4~U 7/8   Pipe Thread P1/8~P1/2	1	20	20	50	40	181	2.0
THLP340-20/MT4	M16~M40	U 5/8~U 3/8   Pipe Thread P1/4~P1 1/8	1.5	20	20	72	50	238	5.5
THLP 460-30/MT5	M22~M50	U 7/8~U1 3/4	2	30	30	95	72	307	

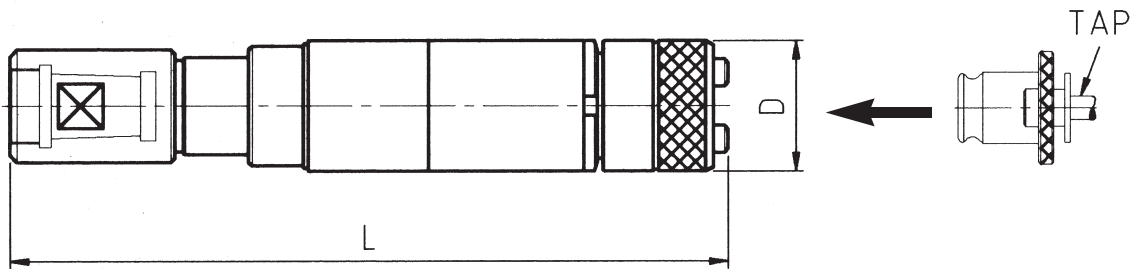

規格	攻牙能力		Float	Length compensation		D	L	Weight(kg)
				Comp.	Exp.			
THLP 030-15/JT2(Thread)	M3~M8	U 1/4~U 5/16	0.25	15	15	23	147	0.25
THLP 140-20 /JT2(Thread)	M3~M14	U 1/4~U 7/16   Pipe Thread~P1/8~P1/4	0.5	20	20	35	172	0.90
THLP 140-20 /JT6(Thread)							176	
THLP 240-20 /JT6(Thread)	M6~M24	U 1/4~U 7/8   Pipe Thread P1/8~P1/2	1	20	20	72	205	1.8



無扭力絲攻筒夾 >>>

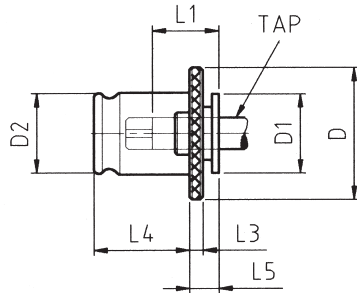

規格	攻牙能力		D	D1	D2	L1	L3	L4	L5	Weight(kg)
TC 0	M3~M8	U 1/4~U 5/16	22	12.5	13	15	4	19.5	7	0.03
TC 1	M3~M14	U 1/4~U 7/16   Pipe Thread P1/8~P1/4	30	19	19	17	4	21.5	7	0.06
TC 2	M6~M24	U 3/8~U 7/8	48	30	31	30	5	35	11	0.25
TC 3	M16~M38	Pipe Thread P1/4~P1/8	70	47	48	44	6	55.5	14	0.8
TC 4	M22~M48	Pipe Thread P3/4~P1 1/2	92	60	60	(33)	13	63	33	1.5

扭力絲攻筒夾 >>>

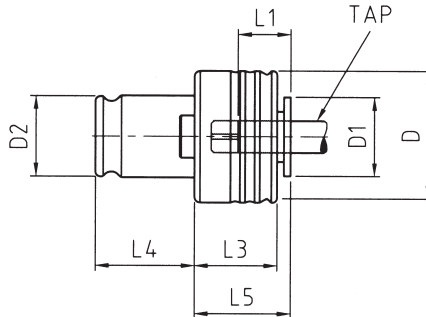

規格	攻牙能力		D	D1	D2	L1	L3	L4	L5	Weight(kg)
TCS 0B	M3~M8	U 1/4~U 5/16	23	12.5	13	15	20	19.5	21	0.06
TCS 1B	M3~M14	U 1/4~U 7/16   Pipe Thread P1/8~P1/4	32	19	19	17	25	21.5	25	0.15
TCS 2B	M6~M24	U 3/8~U 7/8	50	30	31	30	31	35	33	0.55
TCS 3B	M16~M38	Pipe Thread P1/4~P1/8	72	47	48	44	41	55.5	45	1.7
TCS 4B	M22~M48	Pipe Thread P3/4~P1 1/2	95	60	60	(33)	61	63	68	3.3

轉接筒夾 >>>

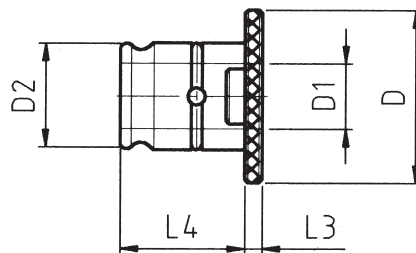

規格	for Adapters Size	D	D1	D2	L3	L4	Weight(kg)
TRE 1/0	0	30	13	19	4	21.5	0.05
TRE 2/0	0	48	13	31	5	35	0.20
TRE 2/1	1	48	19	31	5	35	0.17
TRE 3/1	1	70	19	48	6	55.5	0.65
TRE 3/2	2	70	31	48	6	55.5	0.60
TRE 4/2	2	92	31	60	13	63	1.30
TRE 4/3	3	92	48	60	13	63	1.00